

Hardware included shown on right.

There are extra components in the bolt pack

Tools required:

- 1/2" socket
- 1/2" wrench
- 3/8" nut driver
- Drill

DRILLING INTO VEHICLE IS REQUIRED!

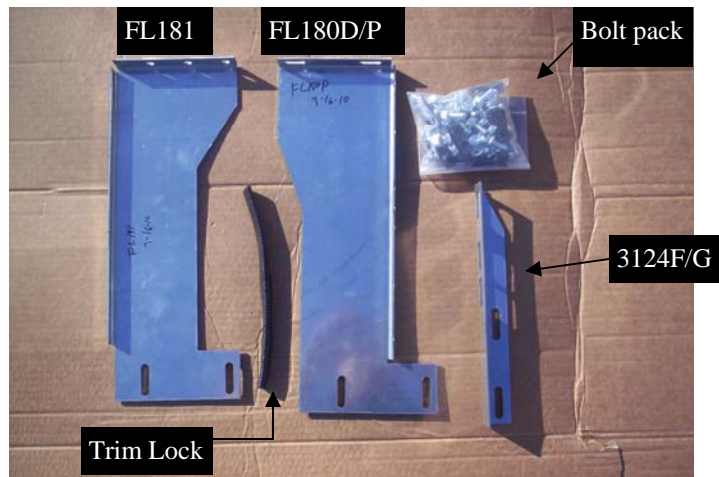

Locate the front bed cross member and install clip nut as shown in **Fig. 1**. If no hole is present you will have to drill a 1/2" hole and insert 8mm pull nut as shown in **Fig. 4**

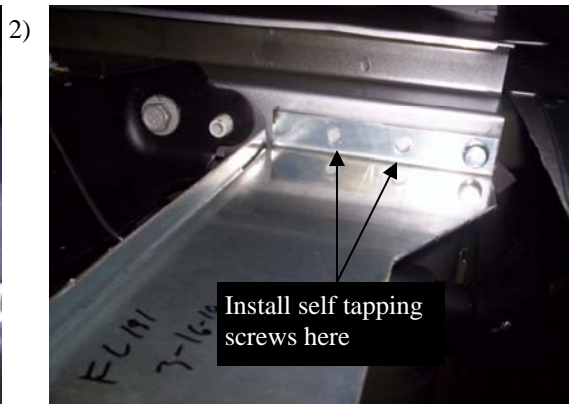

Attach the FL181 bracket to the front bed cross member support, using 5/16" bolt, as shown in **Fig. 2**. Next install self tapping screws into the other holes in the bracket to the cross member.



Cut trim lock to 9-3/4" and attach to FL180D & P as shown in **Fig 3**.



In front of rear wheel, above front leaf spring shackle, on the bed cross member, remove factory bolt holding fender brace. Save bolt you will need it later.

5)



In front of rear wheel, above front leaf spring shackle, on the bed cross member, install 8mm pull nut as in **Fig 5**.

6)



Install FL180 D & P using factory bolt you removed in step 4 and 8mm bolt and washers, as in **Fig. 6**.

7)



Attach a 3124F angle bracket to the FL181 and the 3124G (the longer angle) to the FL180D & P with 5/16" bolts and nuts. Snug but do not tighten at this time.

8)



Apply foam tape to the top lip of the board. Apply the step tread and logo also at this time.

9)



Using self drilling screws attach the board to the angle brackets making sure you are drilling into steel mounting pad. Level board and tighten any remaining loose bolts at this time.



Tighten any and all loose bolts. Repeat all steps for opposite side.