

DRILLING INTO VEHICLE IS REQUIRED

Tools required:

- 13mm socket, 1/2" wrench
- 1/2" socket, 3/8" nut driver
- Drill, 5/16 Drill bit
- Screw driver

1) Measure from the front wheel well toward the rear. At approx. distances of 18", 34", 56", 76" you'll see 2 holes and a rubber plug as shown in **FIG. 2**. At the first 3 locations you'll use bracket # FL176 (note fig. 1 for visual) and FL177 at the rear location. Using the small hole to the rear of the rubber plug on the front 3 bracket locations, insert a pull nut into the hole, holding on to the tab then pull tab and bend over as shown in **FIG. 2**. You are now ready to thread 8 mm bolt with lock and flat washer through the top slot of FL176 and into the threaded pull nut as shown in **FIG. 3**. Straighten bracket and hand tighten. Align bottom of lower tab to bottom of pinch weld **FIG. 3**. Using a 5/16" drill bit you can now drill through pinch weld from outside of vehicle aiming at the hole on the lower tab. Once drilled insert 5/16" flange head bolt from the outside of vehicle and flange nut on the under side. Tighten both bolts and repeat on next 2 brackets.

2) The rear bracket will be a FL177. Remove rubber plug and insert clip nut as shown in **FIG. 4**. Insert a 5/16" flange bolt through the FL177 top flange slot and thread it into clip nut as shown in **FIG 5**. Straighten bracket and hand tighten bolt. Align lower tab of bracket with pinch weld. Drill and install flange bolt and flange nut as described above, tighten all bolts and nuts.

3) If you have plastic molded boards you are now ready to place running board upon mounted brackets, position running board left to right between wheel wells and front to back so it looks good on the vehicle making sure the slots in the bracket align with the steel channel mounted to the bottom of the board. Install self drilling screws thru. Bracket slot and into steel channel as shown in **FIG.6**.

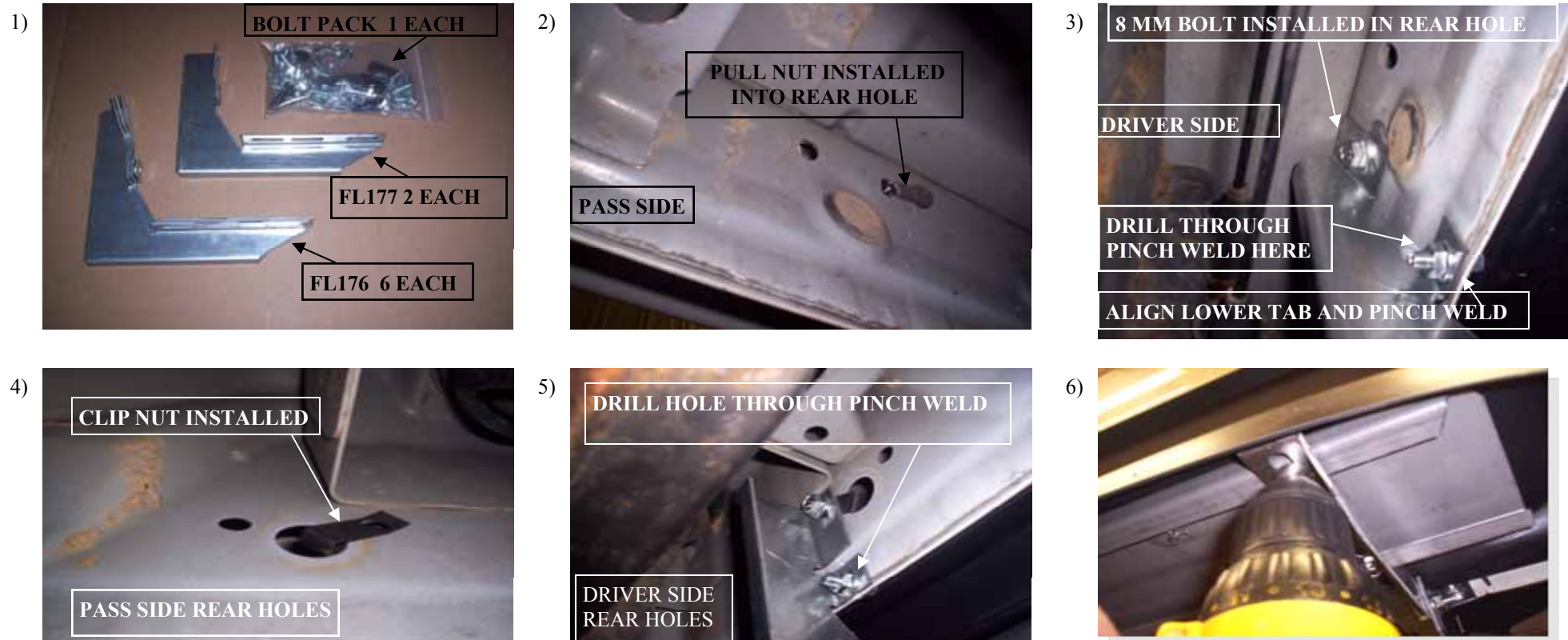



04—CURRENT COLORADO/CANYON CREW CABS

TranSender Running Boards

IN431

Product Nos: 6880-01, 6980-01, 7680-01, 8180-01

- 4) If you are installing aluminum boards, insert sq. head bolts as shown in **FIG.7**, be sure to insert the correct number of bolts matching the number of brackets installed on one side of vehicle.
- 5) Place board on brackets, making sure you have inserted bolts going through bracket as shown in **FIG. 8** position board where needed and install 1/4" flanged nuts then tighten.
- 6) Go to other side of vehicle and repeat steps 1-8.

